



## **Mocha Java Remix ALSB Instructions**

### **Supplies:**

- Mocha Java Remix Kit
- Mocha Java Remix Unmounted Stamps
- 12" Paper Trimmer
- Adhesive
- Rotary Cutter (Tonic Mini Rotary Cutter)
- Sepia Ink (Versafine)
- Black Ink (Palette)
- Large Brass Brads (Color in Black and White)

## Layout #1 and #2



- (2) 12x12 Beige Print
- 12x12 Dark Brown Plain
- (3) 4.25x6.25 Dark Brown Photo Mattes
- Beige Cutouts
- (2) Large Brass Brads

1. Place the 12x12 Beige Print into the trimmer with the printed coffee cups along the right edge. Cut at 8.5 and 6. Rotate the 6x12 piece horizontally and trim at 8 and 4".

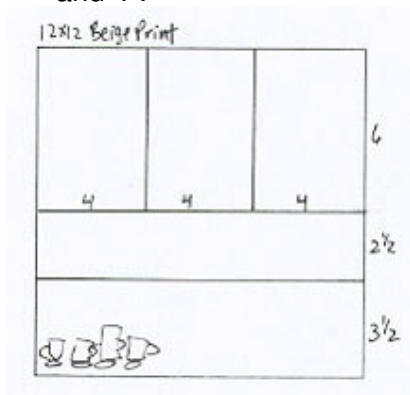

## Layout #3 and #4



- (2) 12x12 Brick Print
- 12x12 Brown Plain
- 12x12 Beige Plain
- .5x5.5 Beige Strip trimmed from the long edge of the Beige Cutouts
- 2.5x11 Beige Plain from layout #1 and #2
- Beige and Translucent Cutouts
- Jute Fiber
- Tan Grosgrain Ribbon

1. Place the Brick print into the trimmer with the printed coffee cup border along the right edge. Trim at 11.25, 9, and 6. Rotate the 6x12 piece and trim horizontally at 8 and 4". Place the 3x12 strip horizontally into the trimmer and cut at 9, 6, and 3 to make four 3" squares.

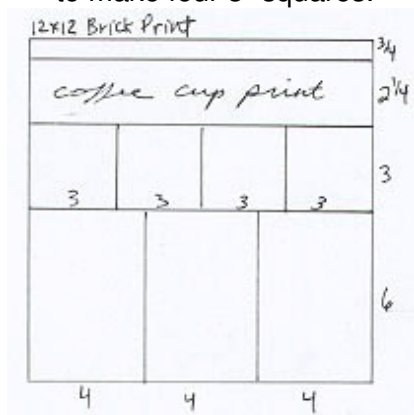

2. Trim the 12x12 Beige Plain at 8.75." Place the 3.25x12 piece horizontally into the trimmer at cut at 8.75, 5.5, and 2.25".

12x12 Beige Plain

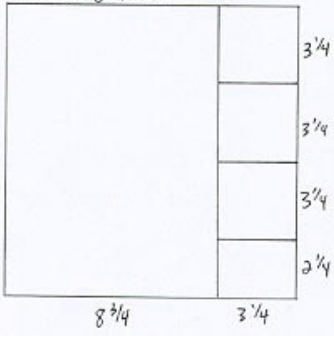

## Layout #5 and #6

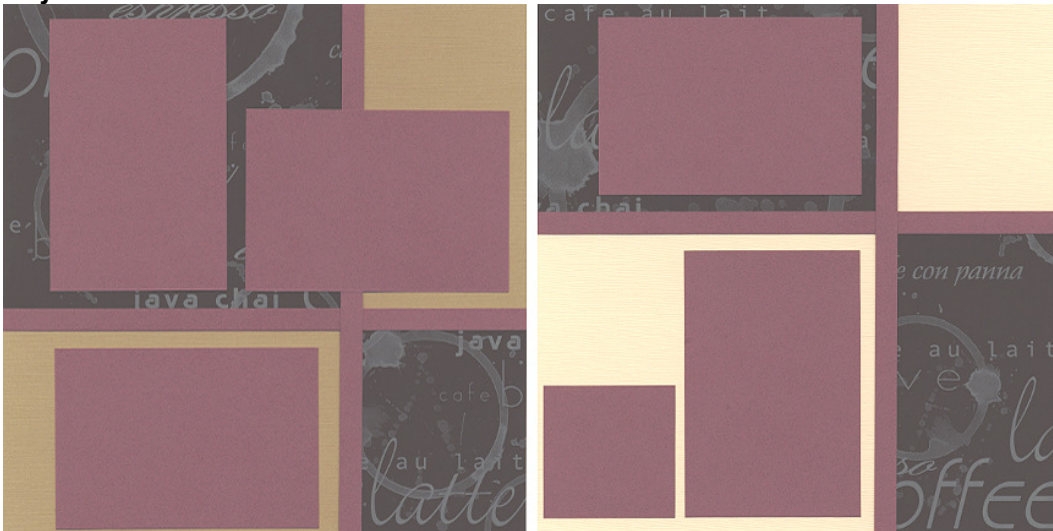

- 12x12 Tan Plain
- 12x12 Beige Plain
- 12x12 Dark Brown Print
- 12x12 Brick Plain
- 3x3 Brick Plain from Layout #3 and #4

1. Trim the 12x12 Brick Plain at 11.5, 11, 10.5, 10, and 6. Rotate the 6x12 horizontally and trim at 8 and 4". Trim the 4x12 piece horizontally at 6".

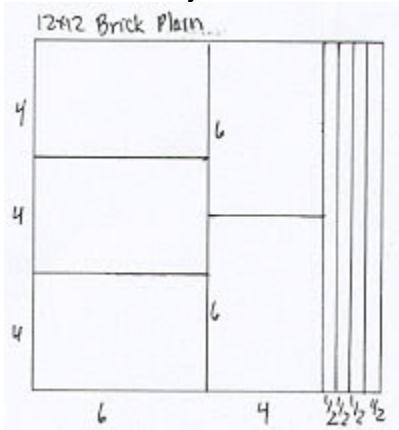

2. Place the 12x12 Dark Brown Print into the trimmer and cut at 8". Rotate both pieces horizontally and trim at 7".

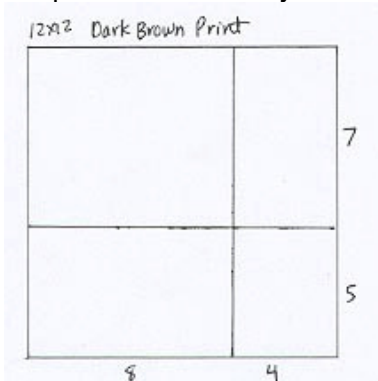

## Layout #7 and #8



- 12x12 Dark Brown Print
- 12x12 Dark Brown Plain
- 8.75x12 Beige Plain from Layout #3 and #4
- 2.25x3.25 Beige Plain
- .75x12 Brick Plain
- Unmounted Rubber Stamps
- Beige Cutouts
- Copper Brads
- Jute Fiber
- Satin Cord
- Burgundy Ribbon
- Sepia Ink
- Black Ink

1. Trim the 12x12 Translucent Plain at 8, 7, and 5.75." Rotate the 5.75x12 piece horizontally and cut at 7.75. Place the 6x12 piece horizontally into the trimmer and cut at 6".

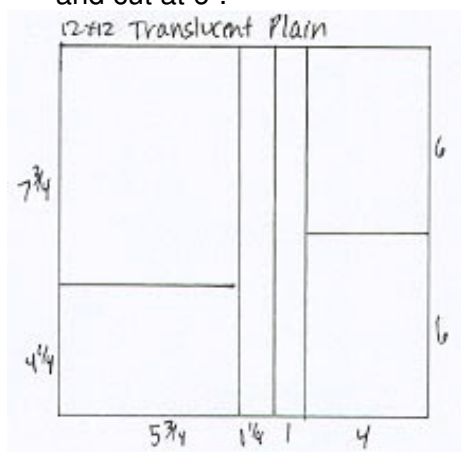

2. Cut the 12x12 Brick Plain in half at 6". Rotate one of the 6x12 pieces and trim at 8".

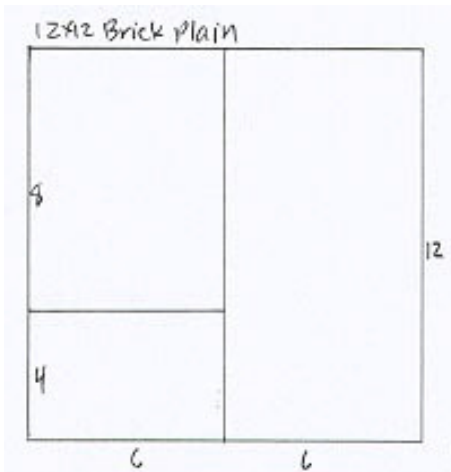

3. Place the 8.75x12 Beige Plain horizontally and trim at 5.25". Rotate the 5.25x8.75 piece horizontally and cut at 7.25".

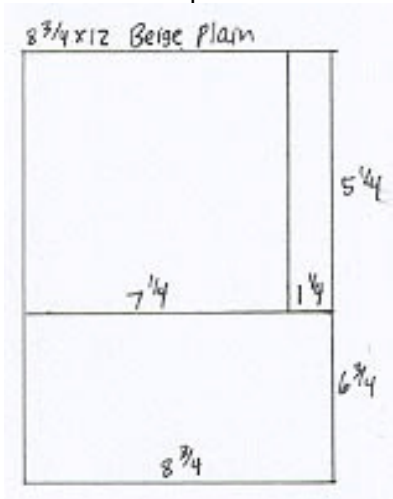

## Layout #9 and #10



- (2) 12x12 Brown Print
- 12x12 Translucent Plain
- (3) 4.25x6.25 Brick Plain
- (2) 4.25x6.25 Beige Plain
- Beige, Translucent and Brown Cutouts
- Jute Fiber
- Unmounted Rubber Stamps
- Sepia and Black Ink

1. Place the 12x12 Translucent on a cutting mat, and free-style cut wavy half-inch lengths from the paper with a rotary blade. Make eleven strips.

