

2010 Club Scrap®  
**Michael Strong Origami**  
**“Countryside”**

**Materials:**

- Michael Strong's Origami “Countryside” Collection*

**Tools and Supplies:**

- Paper Trimmer
- Adhesive
- CS® Grid Ruler

*Measurement Conversions:*

.25 =  $\frac{1}{4}$ "

.5 =  $\frac{1}{2}$ "

.75 =  $\frac{3}{4}$ "



**Layout #1 and #2**

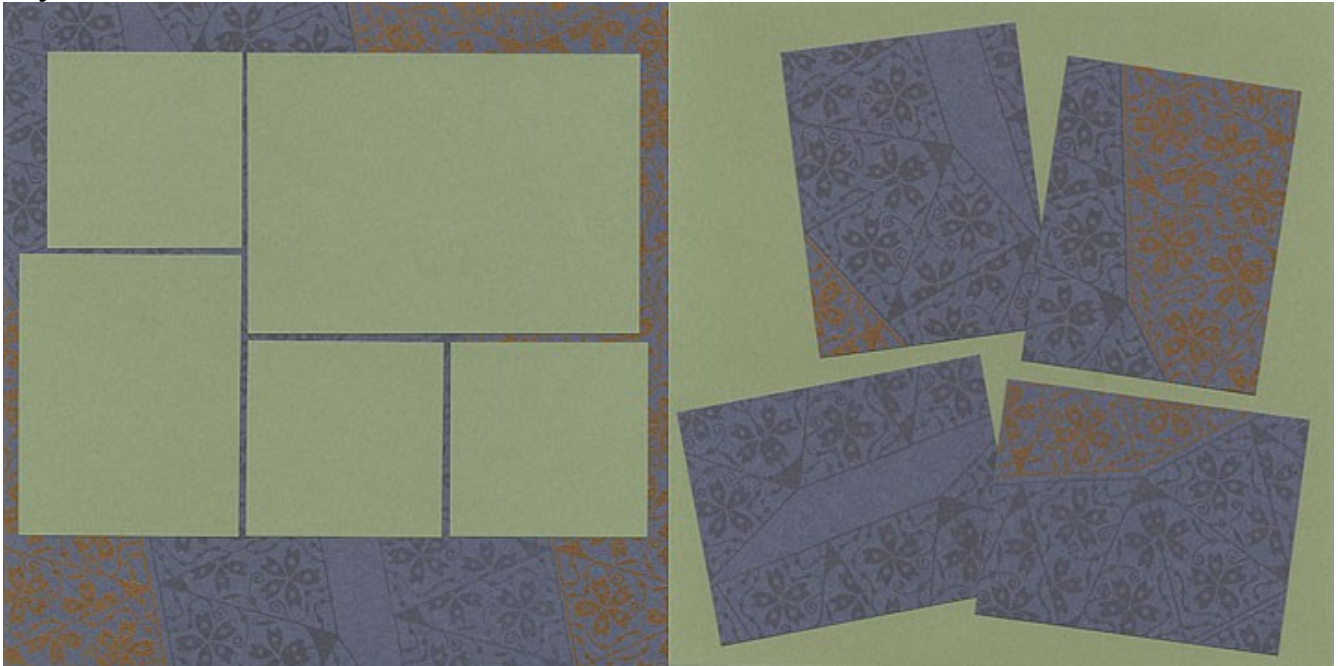

- 12x12 Stonewash Print (Base L)
- 12x12 Green Plain (Base R)
- 8.5x11 Green Plain
- 8.5x11 Stonewash Print

1. Cut the 8.5x11 Green Plain vertically at 5". Trim the 5x11 horizontally at 7". Cut the 3.5x11 horizontally at 10.5, 7 and 3.5".

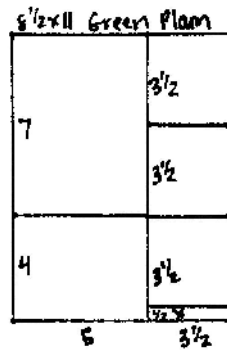

2. Trim the 8.5x11 Stonewash Print vertically at 4.25". Cut each 4.25x11 horizontally at 5.5".

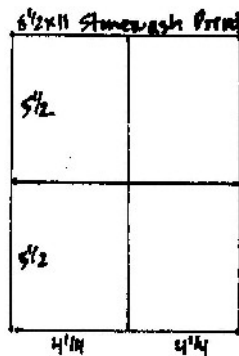

Layout #3 and #4



- 12x12 Ivory Print (Base L)
- 12x12 Grape Plain (Base R)
- 8.5x11 Grape Plain
- 8.5x11 Ivory Print

1. Trim the 8.5x11 Grape Plain horizontally at 10.5 and 6.25". Cut the 6.25x8.5 horizontally at 4.25". Trim the 4.25x8.5 horizontally at 6.25".

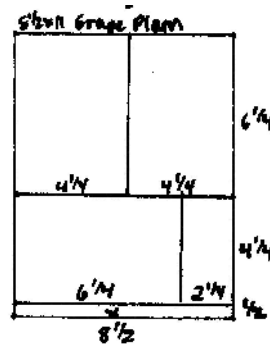

2. Cut the 8.5x11 Ivory Print horizontally at 10, 8 and 4". Trim one 4x8.5 horizontally at 6". Trim the other 4x8.5 horizontally at 8 and 4". Cut the 2x8.5 horizontally at 8 and 4".

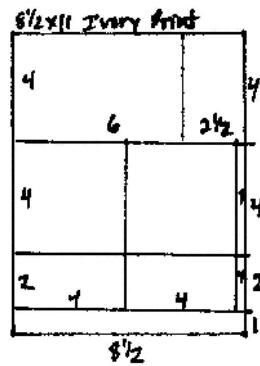

**Layout #5 and #6**

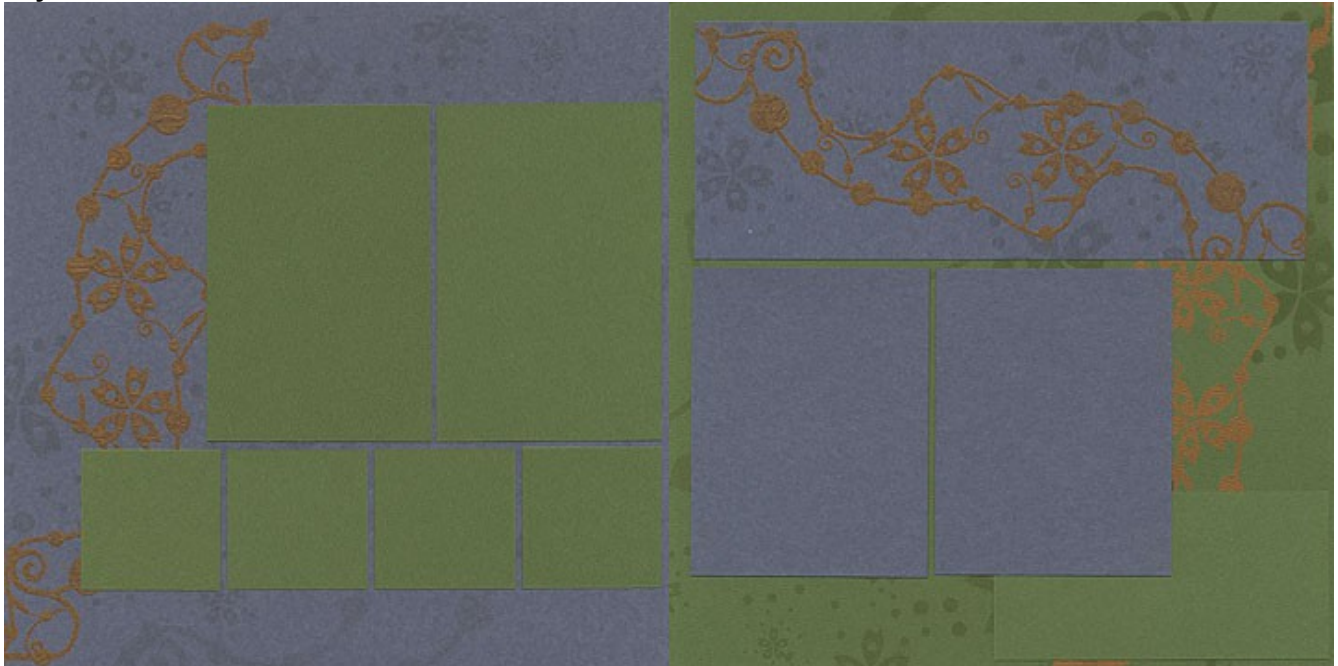

- 12x12 Stonewash Print (Base L)
- 12x12 Green Print (Base R)
- 8.5x11 Green Plain
- 8.5x11 Stonewash Print

1. Cut the 8.5x11 Green Plain vertically at 6". Trim the 6x11 horizontally at 8 and 4". Cut the 2.5x11 horizontally at 10, 7.5, 5 and 2.5".

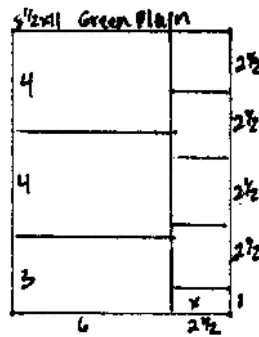

2. Trim the 8.5x11 Stonewash Print vertically at 4.25". Cut one 4.25x11 horizontally at 5.5".

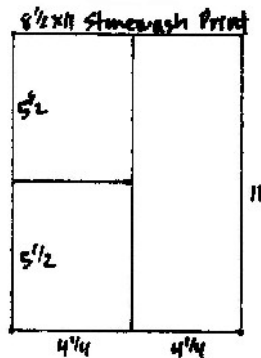

Layout #7 and #8



- 12x12 Green Print (Base L)
- 12x12 Grape Print (Base R)
- 8.5x11 Grape Print
- 8.5x11 Green Print

1. Cut the 8.5x11 Grape Print vertically at 7". Trim the 7x11 horizontally at 10 and 5".

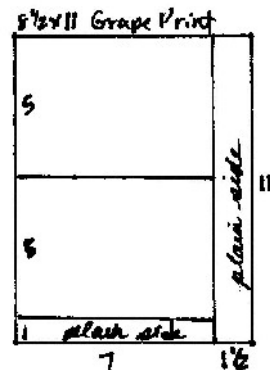

2. Trim the 8.5x11 Green print horizontally at 10.5 and 6.25". Cut the 6.25x8.5 horizontally at 4.25". Trim the 4.25x8.5 horizontally at 6.25".

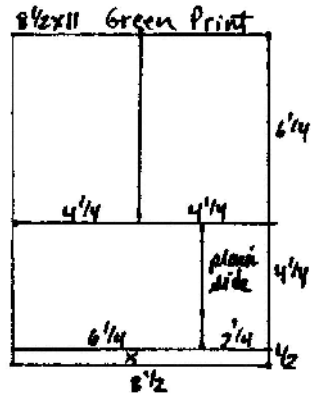

Layout #9 and #10

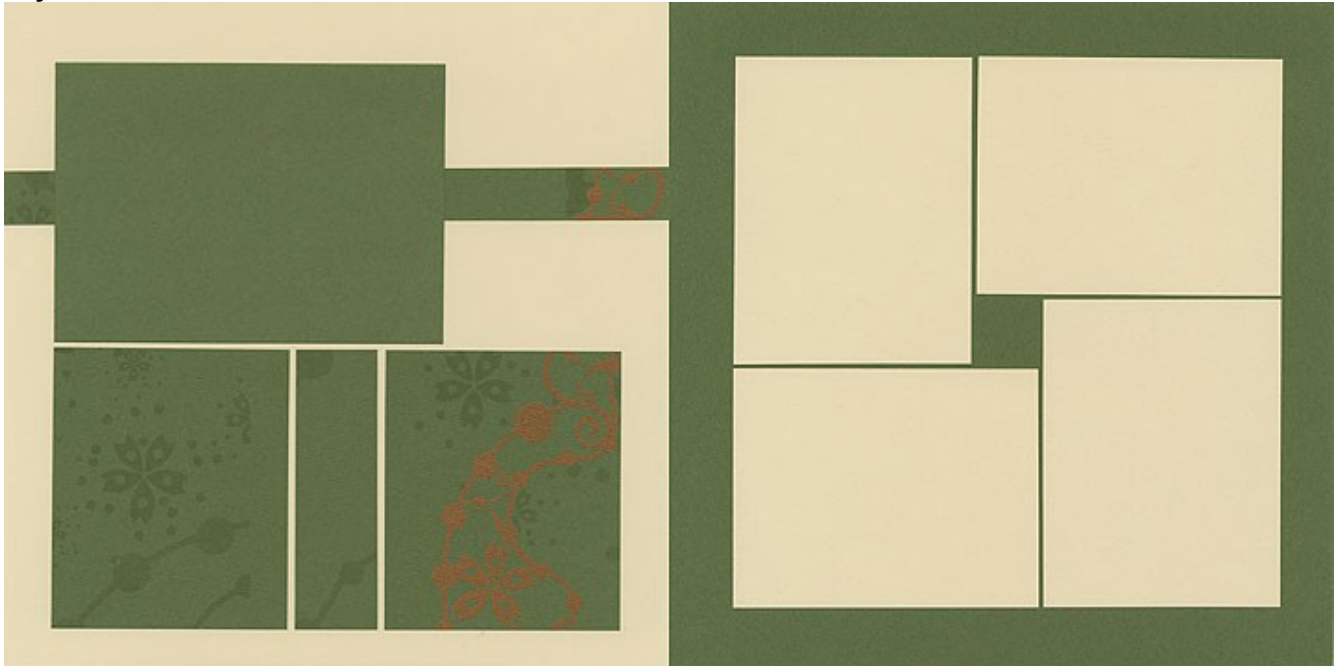

- 12x12 Ivory Plain
- 12x12 Green Plain
- 8.5x11 Green Print
- 8.5x11 Ivory Plain

1. Cut the 8.5x11 Green Print horizontally at 10 and 5". Trim one 5x8.5 horizontally at 4.25". Trim the other 5x8.5 horizontally at 7". Cut the 1x8.5 horizontally at 5".

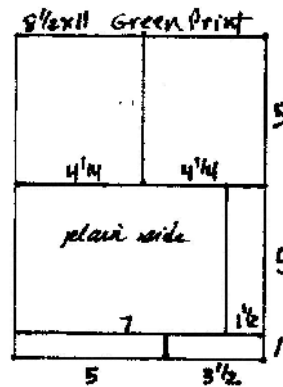

2. Trim the 8.5x11 Ivory Plain vertically at 4.25". Cut each 4.25x11 horizontally at 5.5".

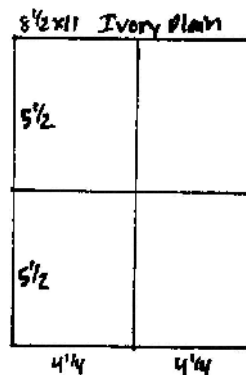

Layout #11 and #12



- 12x12 Green Print (Base L)
- 12x12 Grape Print (Base R)
- 8.5x11 Grape Print
- 8.5x11 Green Print

1. Cut the 8.5x11 Grape Print horizontally at 10.5 and 6.25". Trim the 6.25x8.5 horizontally at 4.25". Cut the 4.25x8.5 horizontally at 6.25".

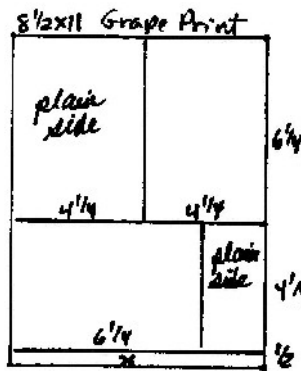

2. Trim the 8.5x11 Green Print vertically at 4.25". Cut each 4.25x11 horizontally at 5.5".

